



TWO COMPARTMENT UNDERMOUNT SINK

PROJECT#: _____

ITEM# _____

MODEL# _____

Model #	Bowl Size L x W x D	Model # L x W	Model #	Bowl Size L x W x D	Model # L x W
UM-2-1212-4.5	12" x 12" x 4 1/2"	25 1/2" x 13 1/2"	UM-2-1616-4.5	16" x 16" x 4 1/2"	33 1/2" x 17 1/2"
UM-2-1212-7.5	12" x 12" x 7 1/2"	25 1/2" x 13 1/2"	UM-2-1616-7.5	16" x 16" x 7 1/2"	33 1/2" x 17 1/2"
UM-2-1212-10	12" x 12" x 10"	25 1/2" x 13 1/2"	UM-2-1616-10	16" x 16" x 10"	33 1/2" x 17 1/2"
UM-2-1416-4.5	14" x 16" x 4 1/2"	29 1/2" x 17 1/2"	UM-2-1916-4.5	19" x 16" x 4 1/2"	39 1/2" x 17 1/2"
UM-2-1416-7.5	14" x 16" x 7 1/2"	29 1/2" x 17 1/2"	UM-2-1916-7.5	19" x 16" x 7 1/2"	39 1/2" x 17 1/2"
UM-2-1416-10	14" x 16" x 10"	29 1/2" x 17 1/2"	UM-2-1916-10	19" x 16" x 4 1/2"	39 1/2" x 17 1/2"

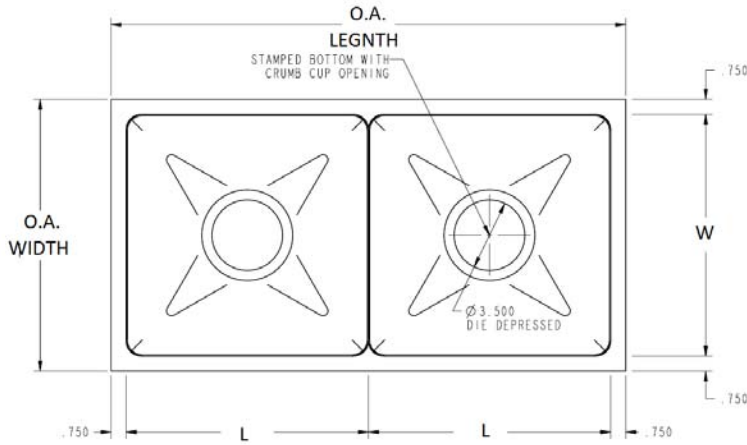

PLAN

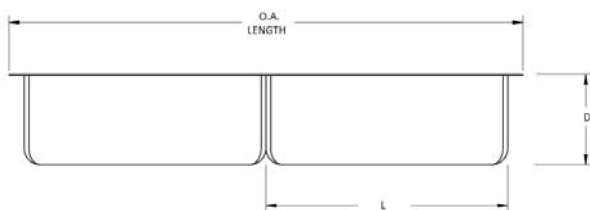

ELEVATION

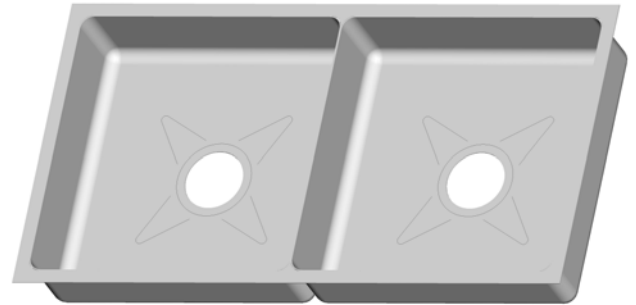

ISOMETRIC VIEW

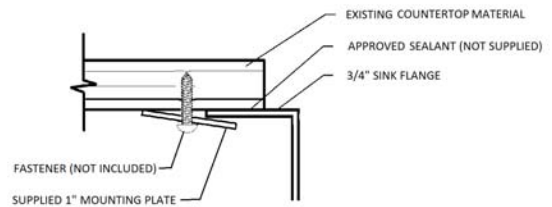

DETAIL SECTION

Mechanical Specifications

- 16 gauge 304 stainless steel fabrication
- 3 1/2" drain opening with crumb cup drain and basket strainer 1 1/2" IPS
- Fully welded, seamless and polished to #3 commercial finish
- Horizontal and vertical corners covered to a 3/4" radius
 - Die formed depression to drain in bowl bottom
 - 1" mounting plate
 - NSF listed and labeled

Optional

- 14 gauge 304 stainless steel fabrication available
 - Different bowl sizes and depths
 - Sound deadening to underside of sink bowl
 - ADA options